

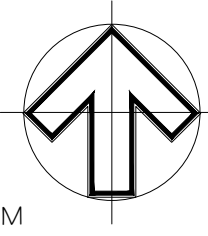

PLEASE NOTE
 FOR CONSTRUCTION PURPOSES USE ONLY FIGURED DIMENSIONS. THIS DRAWING MUST ALWAYS BE READ IN CONJUNCTION WITH ALL RELEVANT PROJECT DETAILS. ALL DIMENSIONS MUST BE CHECKED ON SITE PRIOR TO COMMENCEMENT. PLEASE REPORT ANY DISCREPANCY TO THE ARCHITECT OR CONTRACT ADMINISTRATOR
 © COPYRIGHT XTERIORSCAPES 2023

Revisions
 A0 25/01/22 Initial Design
 A1 23/02/23 For Approval
 A2 08/03/23 For Tender
 A3 03/04/23 For Construction

1:1500
 0 50 100 150M



Drawing
 Landscape Plan
 Project/Client
 Wilfield Stage 11-20
 GW Wilfield Ltd
 Job reference | Drawing number
 22113 01-001

Revision
 A3

Project Date
 Sept 2022
 Scale @ A3
 1:1500
 Purpose of Issue
 Construction

xteriorscapes
 LANDSCAPE ARCHITECTS

441 Papanui Road, PO Box 36-511
 Christchurch 8146
 m: 021 433 418 t: 03 421 8460
 hayden@xteriorscapes.nz
 www.xteriorscapes.nz

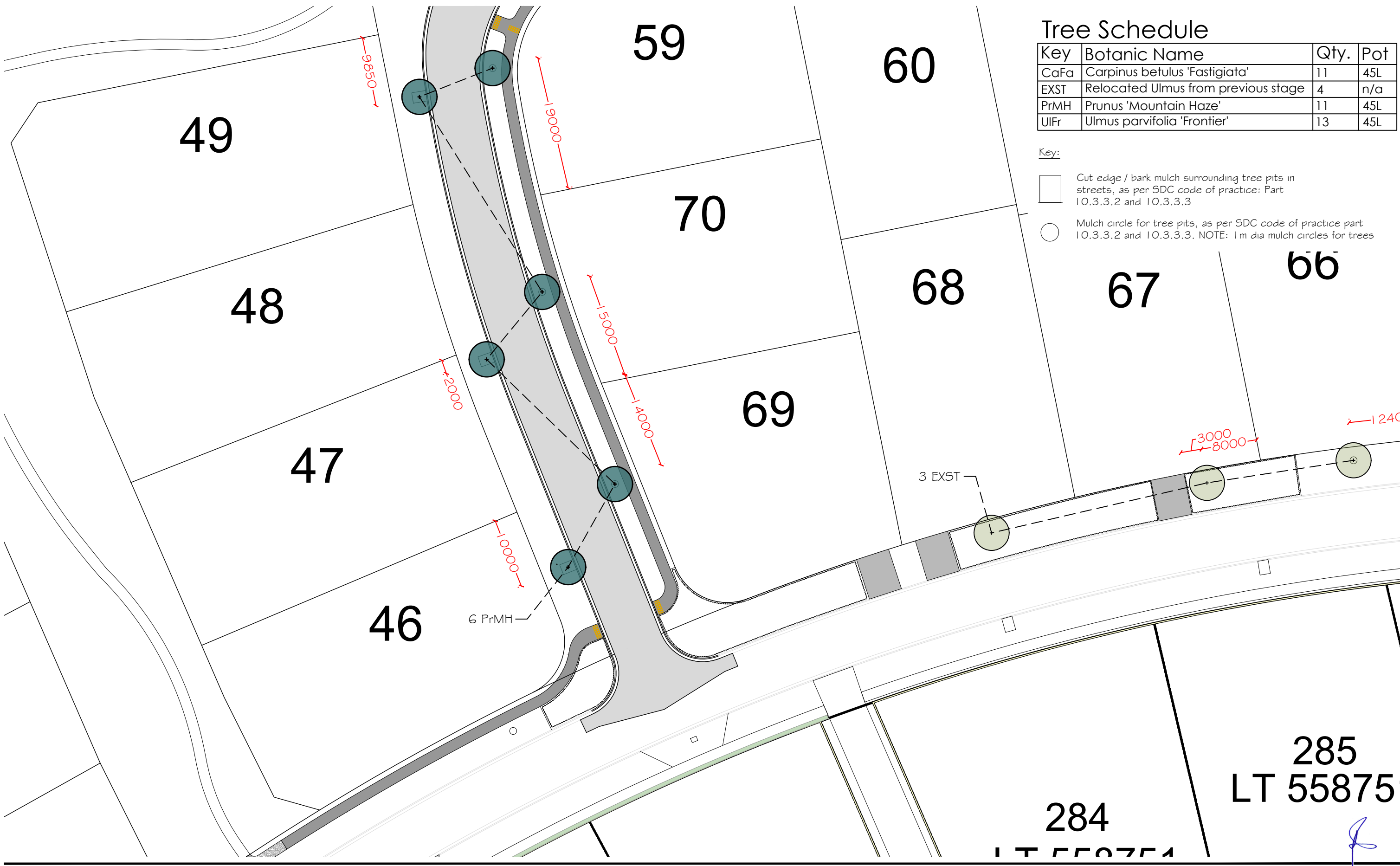

Tree Schedule

Key	Botanic Name	Qty.	Pot
CaFa	Carpinus betulus 'Fastigiata'	11	45L
EXST	Relocated Ulmus from previous stage	4	n/a
PrMH	Prunus 'Mountain Haze'	11	45L
UIFr	Ulmus parvifolia 'Frontier'	13	45L

Key:

- Cut edge / bark mulch surrounding tree pits in streets, as per SDC code of practice: Part 10.3.3.2 and 10.3.3.3
- Mulch circle for tree pits, as per SDC code of practice part 10.3.3.2 and 10.3.3.3. NOTE: 1 m dia mulch circles for trees

PLEASE NOTE
 FOR CONSTRUCTION PURPOSES USE ONLY FIGURED DIMENSIONS. THIS DRAWING MUST ALWAYS BE READ IN CONJUNCTION WITH ALL RELEVANT PROJECT DETAILS. ALL DIMENSIONS MUST BE CHECKED ON SITE PRIOR TO COMMENCEMENT. PLEASE REPORT ANY DISCREPANCY TO THE ARCHITECT OR CONTRACT ADMINISTRATOR

© COPYRIGHT XTERIORSCAPES 2023

Revisions

A0	25/01/23	Initial Design
A1	23/02/23	For Approval
A2	08/03/23	For Tender
A3	03/04/23	For Construction

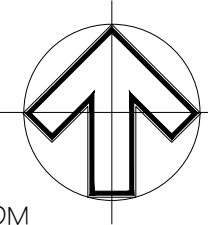
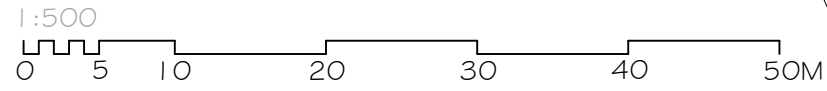

Drawing Tree Plan	Project Date Sept 2022
Project/Client Wilfield Stage 11-20 GW Wilfield Ltd	Scale @ A3 1:500
Job reference Drawing number 22113 01-002	Purpose of Issue Construction
Revision A3	

xteriorscapes
 LANDSCAPE ARCHITECTS

441 Papanui Road, PO Box 36-511
 Christchurch 8146

m: 021 433 418 t: 03 421 8460
 hayden@xteriorscapes.nz
 www.xteriorscapes.nz

285
 LT 55875

284
 LT 550751

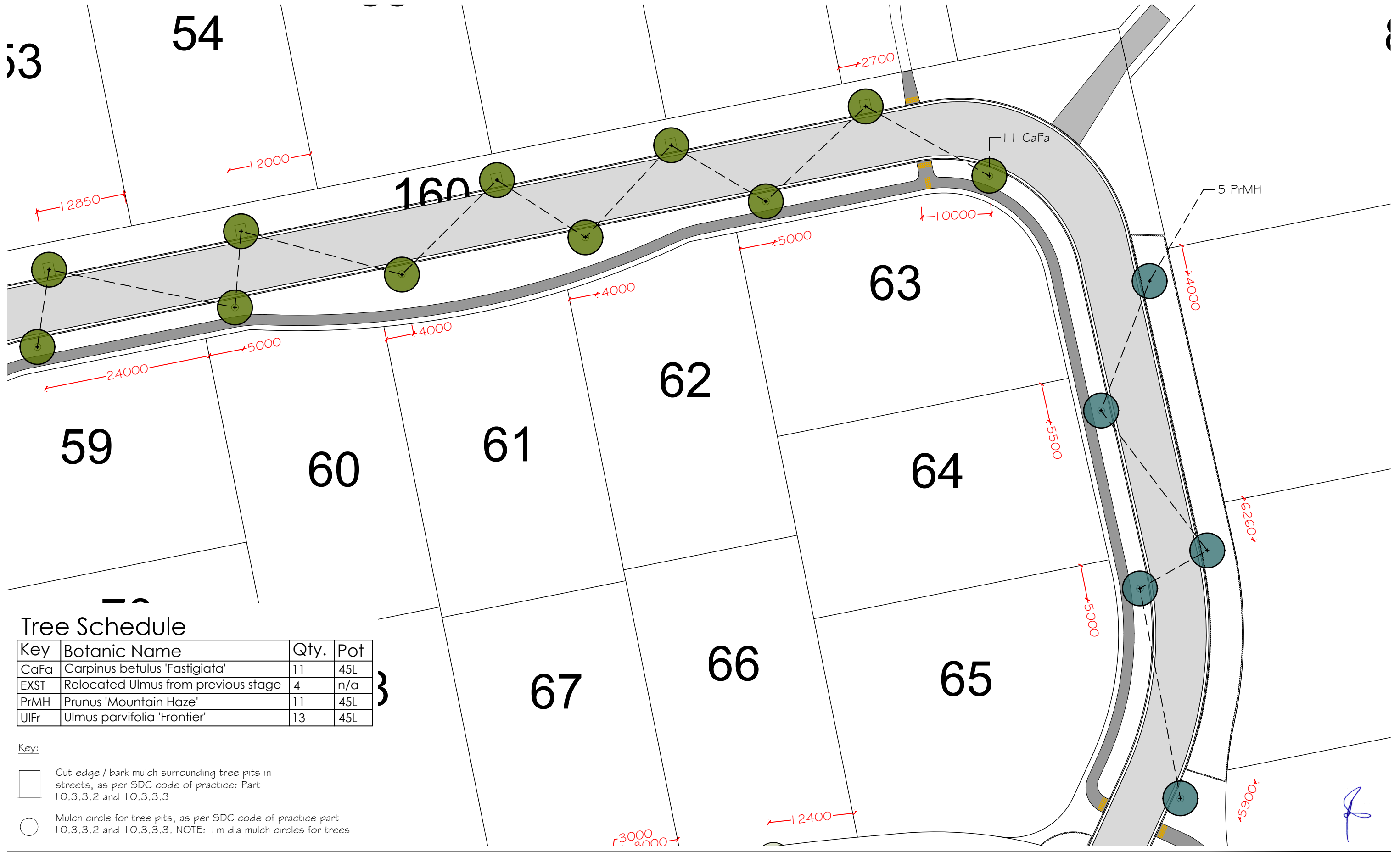

Tree Schedule

Key	Botanic Name	Qty.	Pot
CaFa	Carpinus betulus 'Fastigiata'	11	45L
EXST	Relocated Ulmus from previous stage	4	n/a
PrMH	Prunus 'Mountain Haze'	11	45L
UIFr	Ulmus parvifolia 'Frontier'	13	45L

Key:

- Cut edge / bark mulch surrounding tree pits in streets, as per SDC code of practice: Part 10.3.3.2 and 10.3.3.3
- Mulch circle for tree pits, as per SDC code of practice part 10.3.3.2 and 10.3.3.3. NOTE: 1m dia mulch circles for trees

PLEASE NOTE

FOR CONSTRUCTION PURPOSES USE ONLY FIGURED DIMENSIONS. THIS DRAWING MUST ALWAYS BE READ IN CONJUNCTION WITH ALL RELEVANT PROJECT DETAILS. ALL DIMENSIONS MUST BE CHECKED ON SITE PRIOR TO COMMENCEMENT. PLEASE REPORT ANY DISCREPANCY TO THE ARCHITECT OR CONTRACT ADMINISTRATOR

© COPYRIGHT XTERIORSCAPES 2023

Revisions

A0	25/01/23	Initial Design
A1	23/02/23	For Approval
A2	08/03/23	For Tender
A3	03/04/23	For Construction

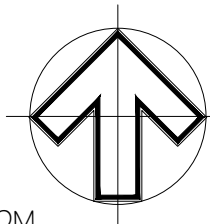
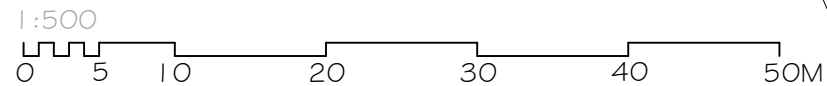

Drawing Tree Plan		Project Date Sept 2022
Project/Client Wilfield Stage 11-20 GW Wilfield Ltd		Scale @ A3 1:500
Job reference Drawing number 22113 01-003	Revision A3	Purpose of Issue Construction



441 Papanui Road, PO Box 36-511
Christchurch 8146
m: 021 433 418 t: 03 421 8460
hayden@xteriorscapes.nz
www.xteriorscapes.nz

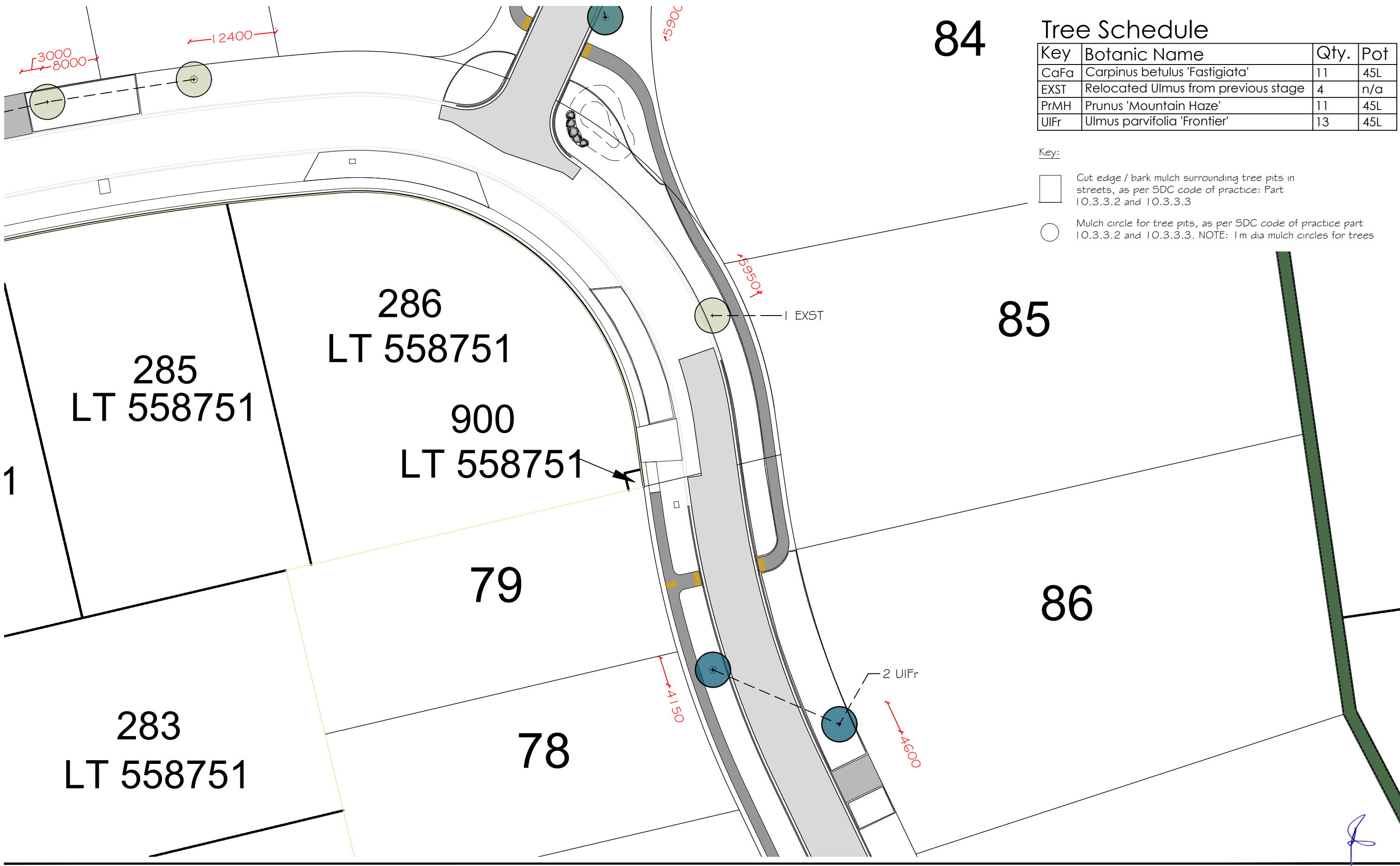

84

Tree Schedule

Key	Botanic Name	Qty.	Pot
CaFa	Carpinus betulus 'Fastigiata'	11	45L
EXST	Relocated Ulmus from previous stage	4	n/a
PrMH	Prunus 'Mountain Haze'	11	45L
UIFr	Ulmus parvifolia 'Frontier'	13	45L

Key:

- Cut edge / bark mulch surrounding tree pits in streets, as per SDC code of practice: Part 10.3.3.2 and 10.3.3.3
- Mulch circle for tree pits, as per SDC code of practice part 10.3.3.2 and 10.3.3.3. NOTE: 1 m dia mulch circles for trees

85

86

PLEASE NOTE
 FOR CONSTRUCTION PURPOSES USE ONLY FIGURED DIMENSIONS. THIS DRAWING MUST ALWAYS BE READ IN CONJUNCTION WITH ALL RELEVANT PROJECT DETAILS. ALL DIMENSIONS MUST BE CHECKED ON SITE PRIOR TO COMMENCEMENT. PLEASE REPORT ANY DISCREPANCY TO THE ARCHITECT OR CONTRACT ADMINISTRATOR
 © COPYRIGHT XTERIORSCAPES 2023

Revisions

A0	25/01/23	Initial Design
A1	23/02/23	For Approval
A2	08/03/23	For Tender
A3	03/04/23	For Construction

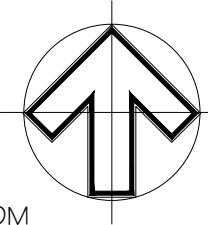

Drawing Tree Plan	Project/Client Wilfield Stage 11-20 GW Wilfield Ltd
Job reference Drawing number 22113 01-004	Revision A3

Project Date Sept 2022
Scale @ A3 1:500
Purpose of Issue Construction



xteriorscapes
 LANDSCAPE ARCHITECTS

441 Papanui Road, PO Box 36-511
 Christchurch 8146
 m: 021 433 418 t: 03 421 8460
 hayden@xteriorscapes.nz
 www.xteriorscapes.nz

Tree Schedule

Key	Botanic Name	Qty.	Pot
CaFa	Carpinus betulus 'Fastigiata'	11	45L
EXST	Relocated Ulmus from previous stage	4	n/a
PrMH	Prunus 'Mountain Haze'	11	45L
UIFr	Ulmus parvifolia 'Frontier'	13	45L

Key:

-  Cut edge / bark mulch surrounding tree pits in streets, as per SDC code of practice: Part 10.3.3.2 and 10.3.3.3
-  Mulch circle for tree pits, as per SDC code of practice part 10.3.3.2 and 10.3.3.3. NOTE: 1m dia mulch circles for trees

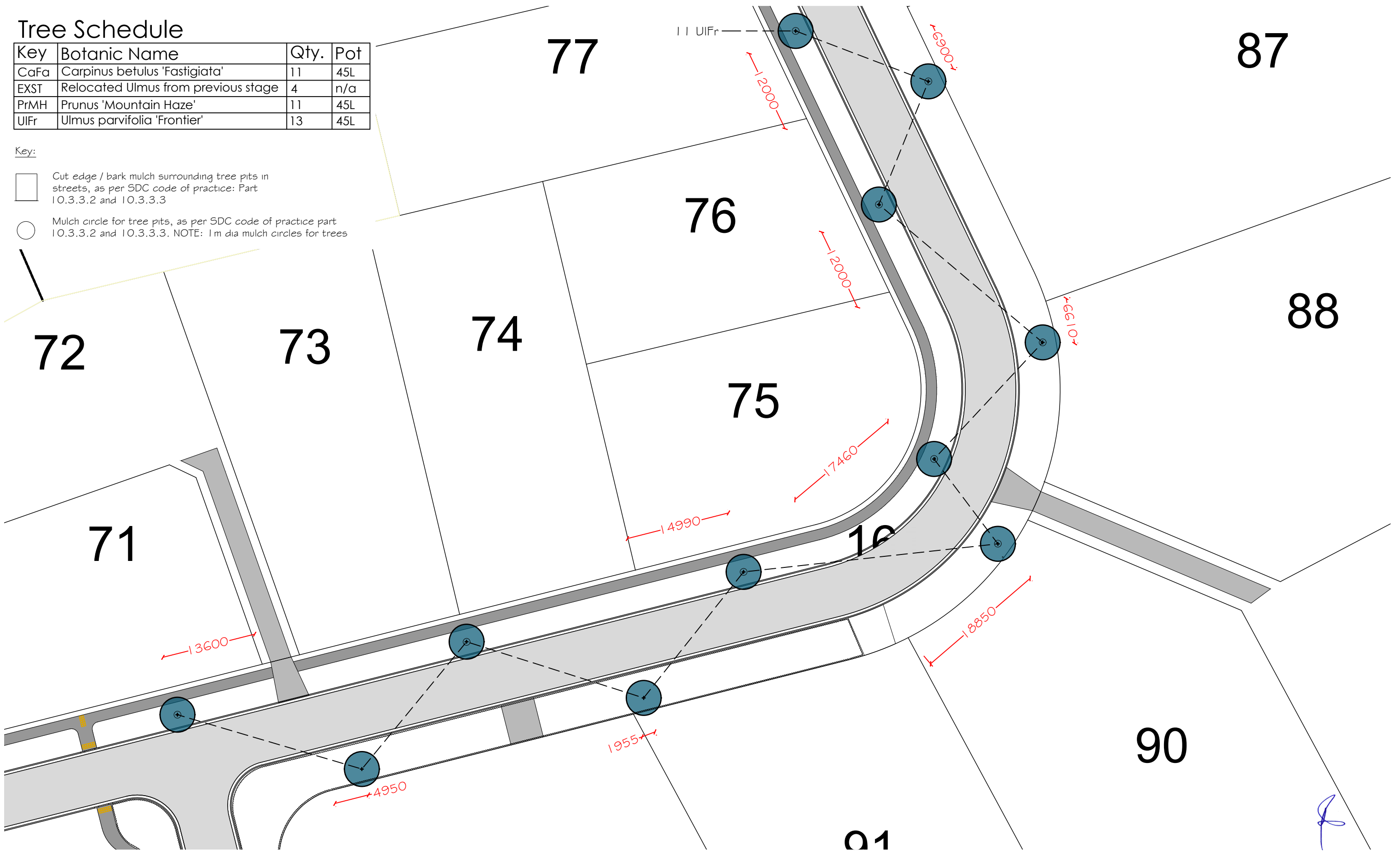

PLEASE NOTE

FOR CONSTRUCTION PURPOSES USE ONLY FIGURED DIMENSIONS. THIS DRAWING MUST ALWAYS BE READ IN CONJUNCTION WITH ALL RELEVANT PROJECT DETAILS. ALL DIMENSIONS MUST BE CHECKED ON SITE PRIOR TO COMMENCEMENT. PLEASE REPORT ANY DISCREPANCY TO THE ARCHITECT OR CONTRACT ADMINISTRATOR

© COPYRIGHT XTERIORSCAPES 2023

Revisions

A0	25/01/23	Initial Design
A1	23/02/23	For Approval
A2	08/03/23	For Tender
A3	03/04/23	For Construction

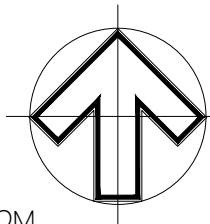
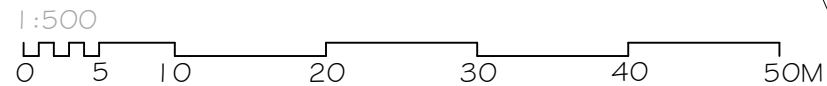

Drawing Tree Plan		Project Date Sept 2022
Project/Client Wilfield Stage 11-20 GW Wilfield Ltd		Scale @ A3 1:500
Job reference Drawing number 22113 01-005	Revision A3	Purpose of Issue Construction



441 Papanui Road, PO Box 36-511
Christchurch 8146
m: 021 433 418 t: 03 421 8460
hayden@xteriorscapes.nz
www.xteriorscapes.nz